

CORP C2  
PLAN TERASA NECIRCULABILA +7.80  
SUPRAFATA TERASA NECIRCULABILA = 599,5 mp

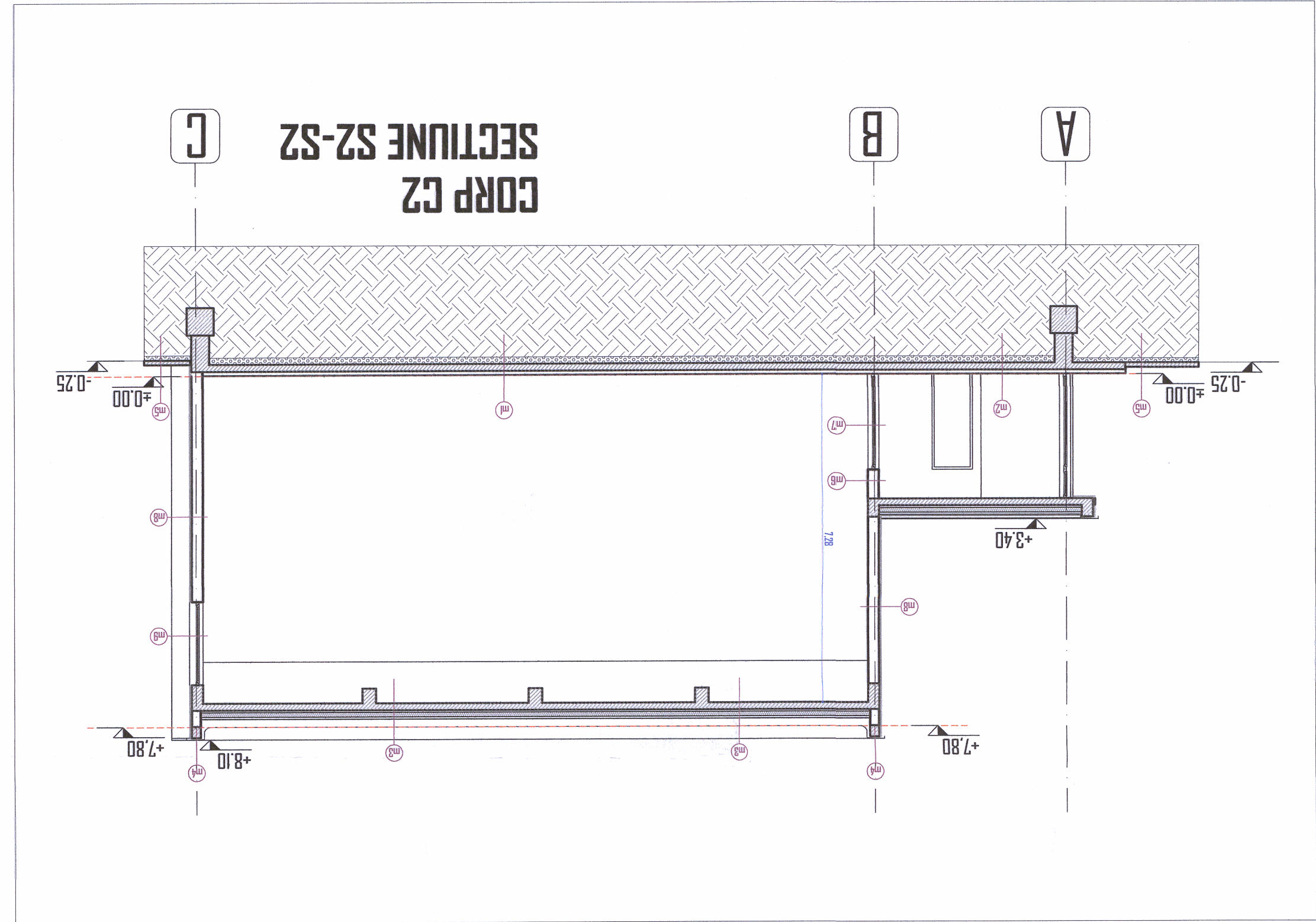

CORP C2  
PLAN PARTER ±0.00  
SUPRAFATA CONSTRUITA = 647,87 mp  
NR. DE PERSOANE = 195

TOTAL SUPRAFATA UTILA									
01	SALA SPORT	416.194	85.700	7.28	16.420	16.840	5.380	17.44	19.420
02	AMEXA	16.840	2.70	2.70	16.420	16.840	5.380	17.44	19.420
03	HOL	16.840	2.70	2.70	16.420	16.840	5.380	17.44	19.420
04	AMEXA	16.840	2.70	2.70	16.420	16.840	5.380	17.44	19.420
05	VESTIAR	16.840	2.70	2.70	16.420	16.840	5.380	17.44	19.420
06	GRUP SANITAR	16.840	2.70	2.70	16.420	16.840	5.380	17.44	19.420
07	HOL	16.840	2.70	2.70	16.420	16.840	5.380	17.44	19.420
08	GRUP SANITAR	16.840	2.70	2.70	16.420	16.840	5.380	17.44	19.420
09	VESTIAR	16.840	2.70	2.70	16.420	16.840	5.380	17.44	19.420
10	HOL	16.840	2.70	2.70	16.420	16.840	5.380	17.44	19.420
11	AMEXA	16.840	2.70	2.70	16.420	16.840	5.380	17.44	19.420
12	CABINET	16.840	2.70	2.70	16.420	16.840	5.380	17.44	19.420
13	AMEXA	16.840	2.70	2.70	16.420	16.840	5.380	17.44	19.420
14	AMEXA	16.840	2.70	2.70	16.420	16.840	5.380	17.44	19.420
15	AMEXA	16.840	2.70	2.70	16.420	16.840	5.380	17.44	19.420
TOTAL SUPRAFATA UTILA									
		591.093	279.860						